

Operating Instruction

CHUTE FEEDER



Henan Hongxing Heavy Machinery Co., Ltd.

The Application and Description of Chute Feeder:

Chute feeder is suitable to be used in ore beneficiation, coal, chemistry and other industrial departments and it is able to take out the granulate massive materials from the storage bin and send

them to different types of material receiving devices, but it is not suitable for feeding concentrate powders or other powdery materials.

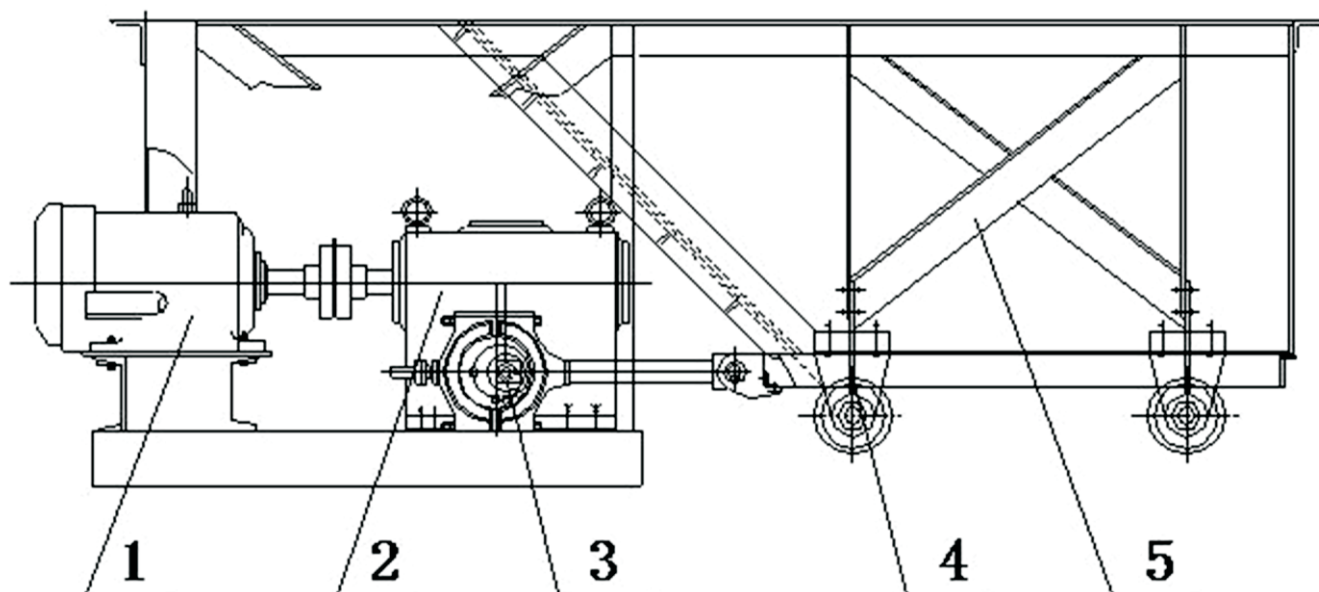

The Advantages and Function of Chute Feeder:

Chute feeder is a kind of feeding machine whose chute base board moves back and forth. It can be lifted at the discharging mouth of the ore storage

bin or installed on the ground and it is mainly used as the feeding equipment for jaw crusher which needs even feeding.

Characteristics:

Processing ability: 10.5–300 t/h

Feeding size: 205–300 mm

Outlet size: 600×500–1000×1900 mm

Power: 4–7.5 kw

Applied material: powdery, granular materials



Working principle

Chute feeder can be installed on the ground or lifted at the discharging mouth of the ore storage bin. The chute base board moves back and forth and the frequency of stroke are 20-60 times per minute and the stroke is 20-200mm.



Features

The stroke can be properly adjusted by the eccentric gear of the driving device and the eccentric distance is half of the stroke. When feeding sticky ores, the eccentric distance of the chute feeder should not be shorter than 30mm according the production experience of some ore beneficiation plants. The width of the chute of chute feeder should 2-2.5 times of the maximum feeding granularity. The biggest chute feeder can satisfy the feeding of iron ore whose granularity is smaller than 500mm. The commonly used chute feeder is 980*1240 feeders whose feeding granularity is 350-0mm and that is suitable for feeding the 400*600 jaw crusher.

Technical data :

Specification	Discharge opening (W×v×H) (mm×mm)	Max. feeding size (mm)	Reciprocating frequency of trough (min ⁻¹)	Feeding capacity (t/h)	Power (kw)	Dimensions (L×W×H) (mm×mm×mm)	Total weight (kg)
600×500	600×500	205	38.9	10.5-25.5	4	2750×910×855	1054
980×1240	980×1240	350	23.7	36-90	7.5	3560×1000×1070	1700
1000×1900	1000×1900	300	27	300	7.5	3900×1590×1340	2691

HXJQ[®]

China Largest Mining Machinery
Manufacturer



- **Pre-sale services: enthusiasm**

We provide you with the prophase plan, process flow design and manufacturer equipment according to your special demand.

- **Sale services: servant**

Send technicians to the jobsite for guiding the installation and adjustment, training operators and finishing the check and accept together with you.

- **After-sale services: faithfulness**

To establish long term friendship, we will regularly pay return visit to customers. Supplying technique, building design, instruction , installation